

MADDOX



Gisa

43.5M (143FT) | 10 GUESTS | 5 CABINS | MENGI YAY YACHTS | 2023

ASKING \$29,500,000



Gisa *redefines* what can
be achieved with a 40 metre
yacht... *she feels closer to 60.*

WILL HARRISON, CEO

Nominated at the *World Superyacht Awards 2024* for Displacement Motor Yachts below 500GT (40m to 44.9m), *Gisa* leaves the *impression of a much larger yacht*.

Everywhere are full-height windows giving panoramic views and abundant natural light, creating a seamless connection with the ocean.













Designed inside and out by VYD Studio in a modern and stylish vernacular, *Gisa* comfortably accommodates ten guests in five generous cabins, including a VIP, a double, a twin and a three-bed cabin that is ideal for children. Then there is the full-beam owner's stateroom, a luxurious space with a beautiful en suite and capacious walk-in wardrobes. There are seven on-board crew to ensure your every comfort is catered to.

Step out onto the large decks, and you will find a host of entertainment and relaxation possibilities. The gorgeous stern pool, beach club, deck jacuzzi and alfresco dining areas are made for bringing people together. Plus the beauty salon is a welcome retreat to rejuvenate and relax.

Gisa has a steel hull and aluminium superstructure, with teak decks, and is powered by twin diesel Caterpillar engines to comfortably cruises at 11 knots, with a maximum speed of 14 knots and a range of up to 2,300 nautical miles.

She offers a unique opportunity, whether for your own personal use or a charter-ready investment.

Specifications

	LENGTH	43.5M / 142'9"FT		DRAFT	2.7M
	YEAR	2023		BEAM	8.8M
	BUILDER	MENGI YAY YACHTS		HULL MATERIAL	STEEL
	GRT	464		RANGE	2,300NM
	GUEST CABINS	5		GUESTS	10
	MAX SPEED	14 KNOTS		CRUISING SPEED	11 KNOTS

KEY FEATURES

- ★ Virtually new
- ★ Very high-end specifications
- ★ Beach Club with folding wings
- ★ Swimming pool
- ★ Full height windows
- ★ Charter ready

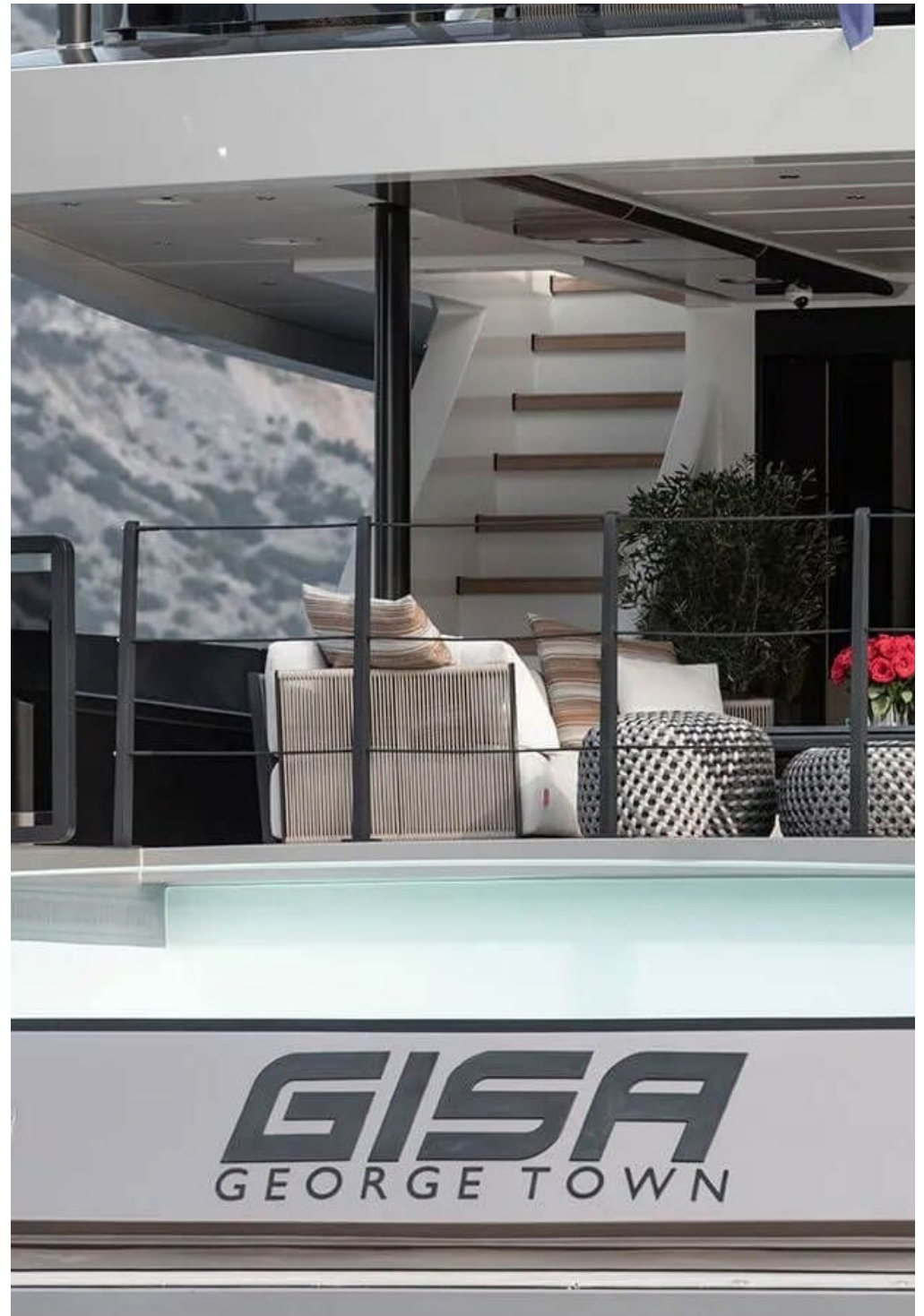



TOYS & TENDERS

- ✓ A large selection of toys and tenders

QUARTERS

Gisa can accommodate up to 10 guests in five suites including one VIP cabin, a double cabin, a twin cabin and a three-bed cabin perfect for children. The full beam master is modern and inviting with large windows, beautiful ensuite and his & hers walk-in wardrobes.



TECHNICAL INFORMATION

- ✓ Length: 43.5m
- ✓ Year: 2023
- ✓ Gross Tonnage: 464
- ✓ Beam: 8.8m
- ✓ Max Draft: 2.7m
- ✓ Builder: Mengi Yay Yachts
- ✓ Hull Construction: Steel
- ✓ Superstructure Construction: Aluminium
- ✓ Exterior Designer: VYD Studio
- ✓ Interior Designer: VYD Studio
- ✓ Engines: 2 x Caterpillar Inboard
- ✓ Generators: 2 x CAT C18
- ✓ Flag: Cayman Islands
- ✓ Guest Cabins: 5
- ✓ Guests: 10
- ✓ Cruising Speed: 11 Knots
- ✓ Max Speed: 14 Knots
- ✓ Range: 2,300nm

Deck Plans

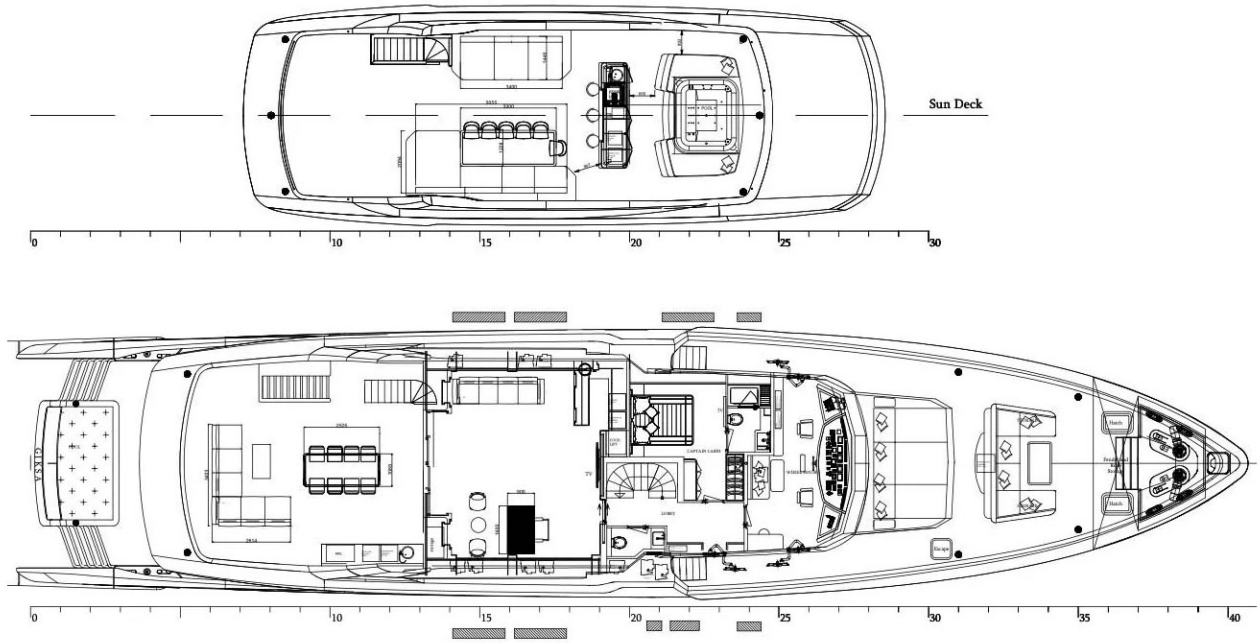

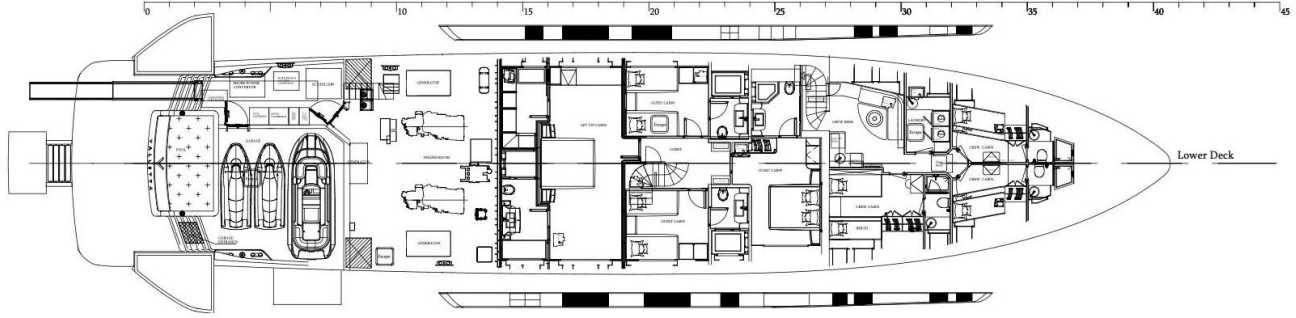
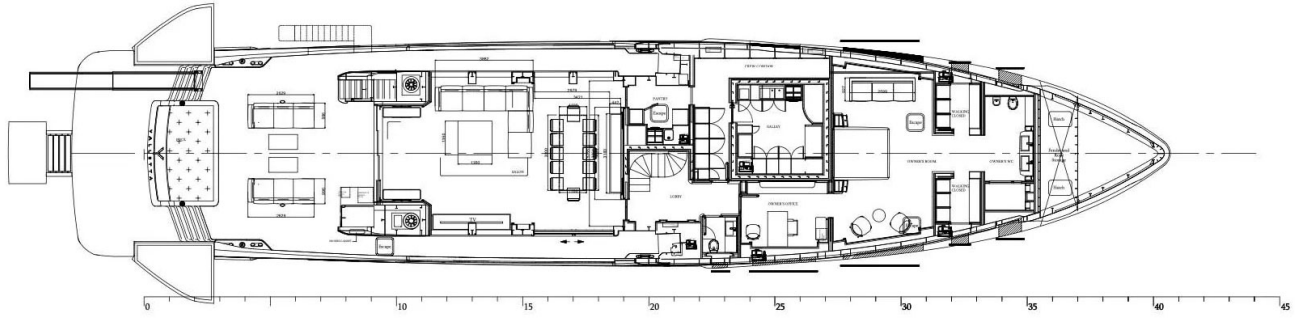

Gallery

















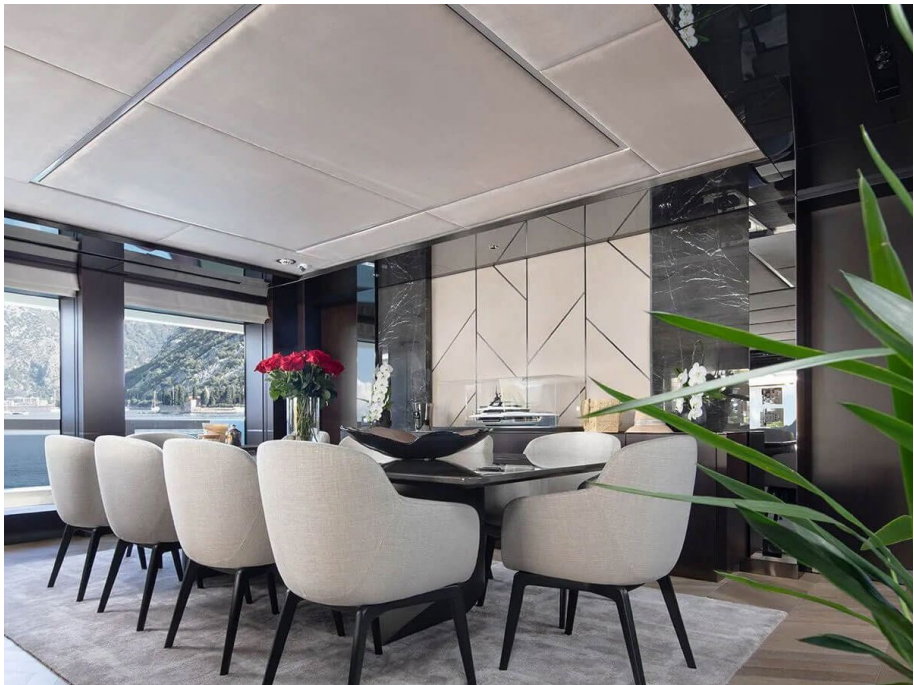









MADDOX

If you have *any questions* relating
to this *superyacht* please email us
enquiries@maddox.yachts